

PRAISE Thematic Report: The business case for Managing Road Risk at Work

Dr Will Murray
Interactive Driving Systems



Why manage road risk at work?

Why?

- Societal:
 - Driving is biggest risk workers, commuters & local communities face
- Legal:
 - OHS - Framework Directive 89/391/EEC
 - Vehicle is part of workplace for OHS
- Business:
 - Good practice, reputation, brand, CSR, procurement
- Financial:
 - Cost models & risk financing

Examples

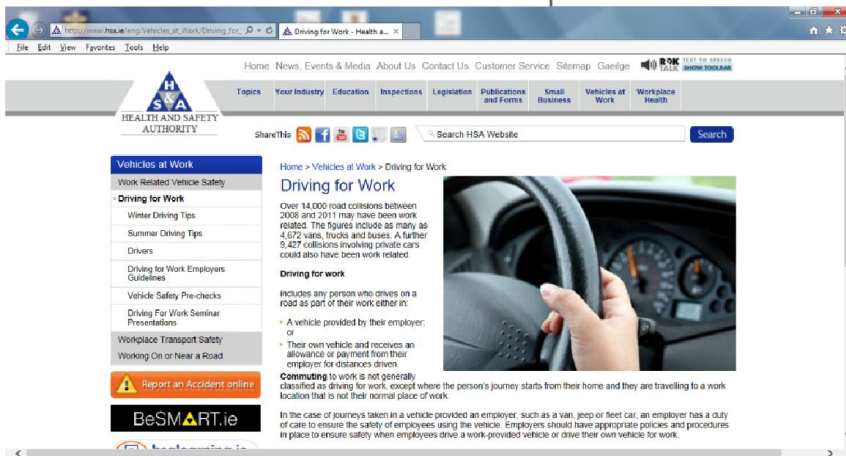
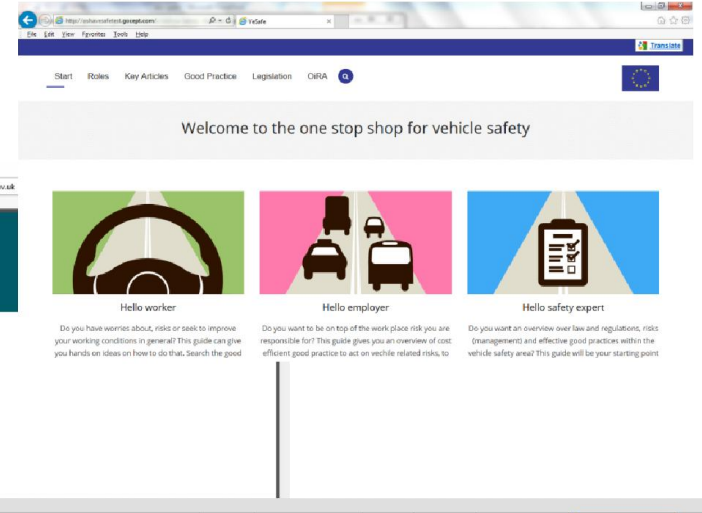
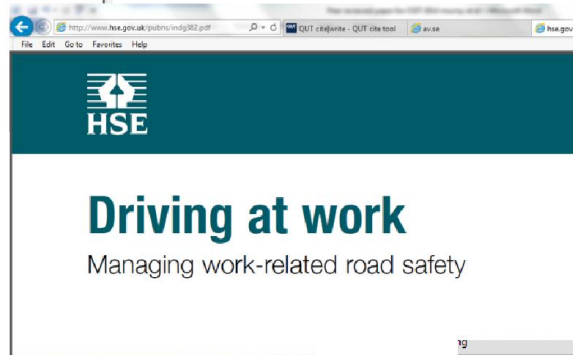
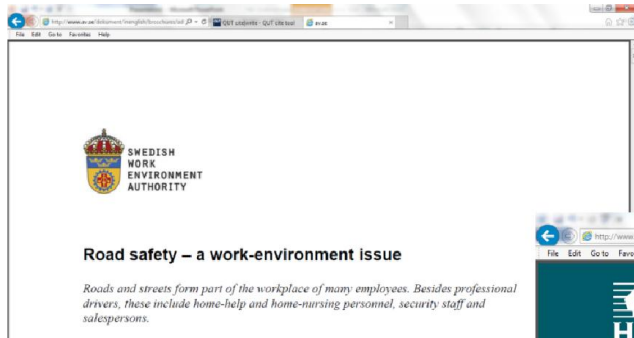

Cost model

Item of Cost	Sample data
Own damage costs	£\$€1,000
Third party vehicle damage costs	£\$€1,000
Third party injury costs	£\$€1,000
Reported cost of collisions	£\$€3,000
Total cost (including hidden costs @ 2 times reported costs)	£\$€6,000
Revenue required to fund collisions at 10% Return on Sales	£\$€60,000
Product sales (at £\$€2) required to fund fleet safety costs	30,000

Model has been successfully applied by organisations all around the world.
5 year 'what-if' spreadsheet template available on request
will.murray@virtualriskmanager.net

Praise thematic report

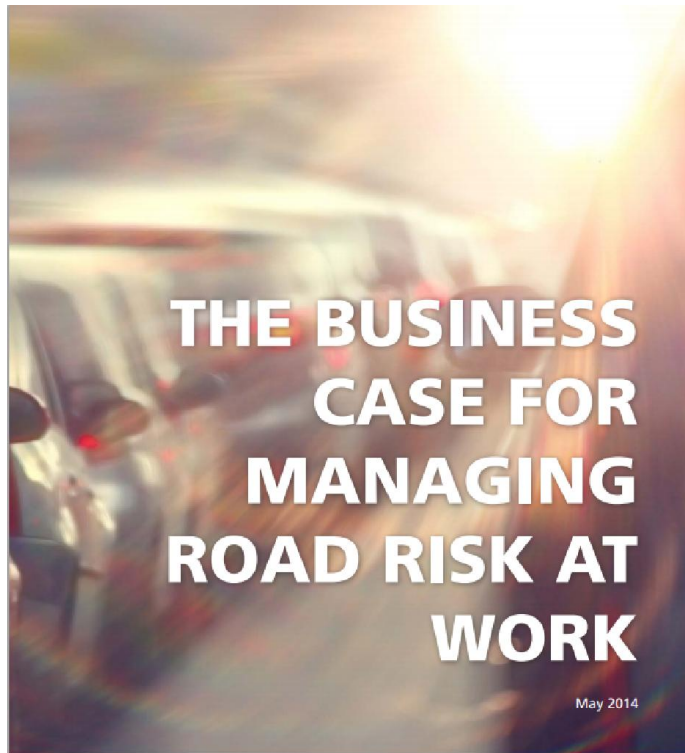

- Focuses on understanding exposures & making strong business case
- Advocates a systems-based approach & evaluation



CONTENTS

Executive Summary	5
1. Introduction	6
1.1 Scope of the problem	6
1.2 Does my organisation need to manage road safety?	8
1.3 Saving money and protecting your organisation - outlining the business case	9
1.4 Legal compliance	9
2. The Business Case for Work-Related Road Risk Management (WRRRM)	11
2.1 Financial benefits	11
2.2 Administrative benefits	15
2.3 Non-financial benefits	15
2.4 Competitive advantage	16
2.5 Road safety and corporate social responsibility (CSR)	17
3. Work-Related Road Risk Management (WRRRM) Models	19
3.1 The ISO international standard 'Road Traffic Safety Management System'	19
3.2 The Haddon Matrix	20
4. How Risk Management Helps the Business Case	23
4.2 The importance of risk assessment	23
4.3 Reducing road risk – avoiding journeys and choosing the safest modes	24
4.4 Journey planning	25
4.5 Managing speed	26
4.6 Managing fatigue	27
4.7 Vehicle management	28
5. Monitoring and evaluation	30
6. Peer-to-peer exchange	33

Evaluation



Rate of Incidents per 10,000 Orders

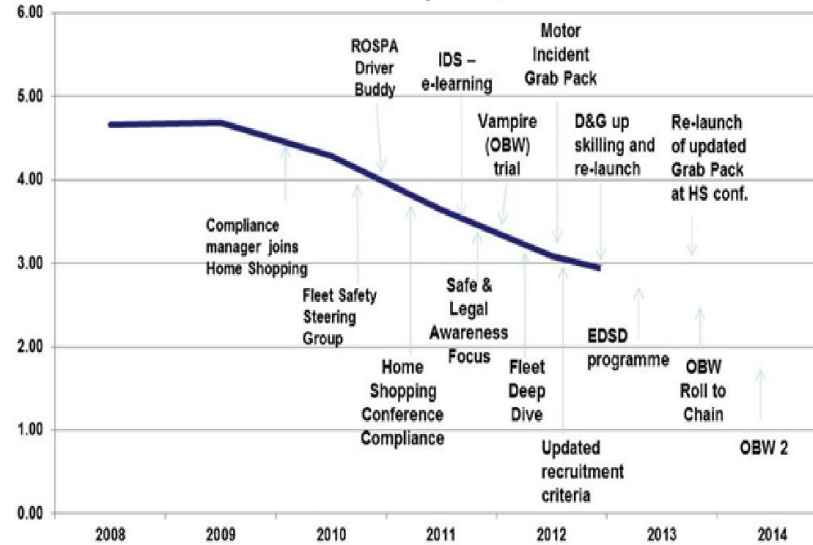

Risk assessments v claims per 1,000 vehicles

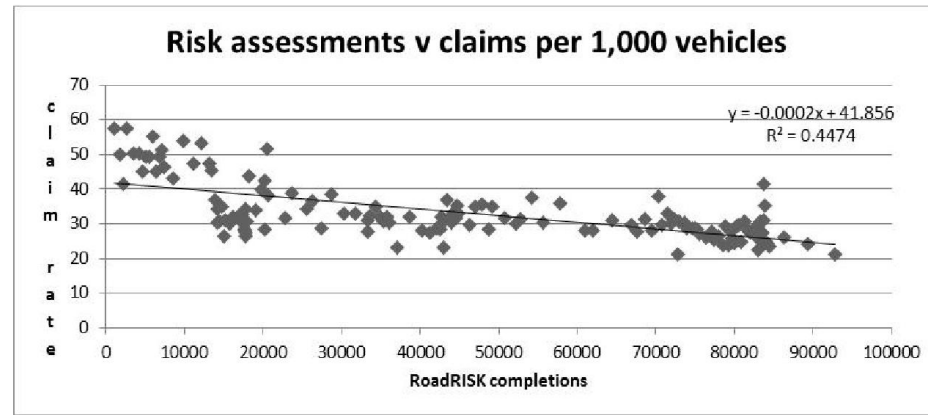

Summary/recommendations

- Understanding exposures & making a business case are key starting points for managing road risk at work
- OHS-led systems based approach recommended
- Compliance, CSR, commercial, £\$€, contractor, community & career development
- Next step:
 - Many good practice cases being presented
 - Utilise ETSC PRAISE thematic reports